

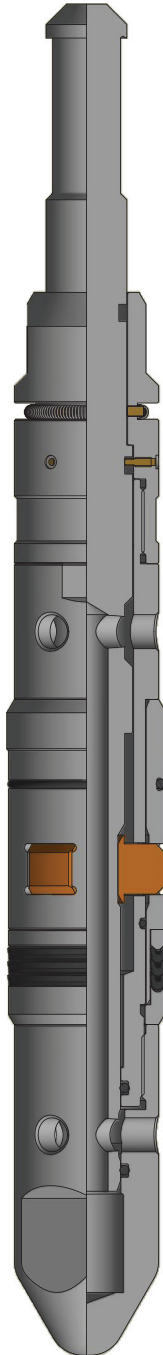

## Black Gator® Blanking Plug



The Black Gator® Blanking Plug prevents pumped fluids from re-circulating via the bypass tubing during Electric Submersible Pump (ESP) operations. The plug is set in the telescopic swivel nipple to plug the bypass port of the Black Gator® Y-Tool and is pressure tested before shipment. The plugs are a compact design with locking dogs located above the seals to prevent damage to the nipple seal bore area. The plugs can be installed or retrieved with slickline or coiled tubing. A fluid bypass feature prevents the plug from swabbing-in the well fluid. The plugs have a top no-go profile and are positively set in the nipple by jarring down. Jarring down shears screws on an internal shaft and sets the locking dogs in the nipple profile. This movement allows the secondary set of shear pins to engage and locks the plug in place and closes the equalizing ports. The external 'V' packing on the plug completes the seal with the nipple. The plugs are retrieved by jarring upwards on the fishing neck. Upward jarring shears the pins on the shaft which allows upward movement of the internal shaft to disengage the locking dogs and opens the pressure equalizing ports to facilitate retrieval.

### FEATURES

- Compact design
- Fluid bypass and equalizing feature
- Jar down to set
- Jar up to release
- 1.875", 2.312", 2.562", 2.750", 2.812" sizes for "D" type nipples
- 1.188" external fish neck except 1.875" design that has 1.00" fish neck
- Redress kit to change nipple sizes (standard base unit design)

### SPECIFICATIONS

- Low alloy steel or 13Cr material options to specification API 5CT
- 5,000 psi MWP
- Up to 350° F
- Viton® or Aflas® seals as standard

Part Number	NO-GO Dia. (in.)	Seal Dia. (in.)	Fish Neck Dia. (in.)	Running/ Pulling Tool
BP-1875-01	1.901	1.875	1.00	1.250 JDS
BP-2312-01	2.350	2.312	1.188	1.500 JDS
BP-2562-01	2.610	2.562	1.188	1.500 JDS
BP-2750-01	2.800	2.750	1.188	1.500 JDS
BP-2812-01	2.865	2.812	1.188	1.500 JDS