

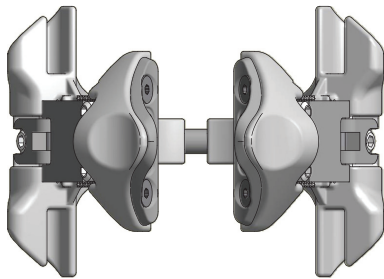

Black Gator® Bypass Tubing Clamp



The Black Gator® Bypass Tubing Clamp is designed to provide full protection to the Electric Submersible Pump (ESP) motor lead extension (MLE) cable and auxiliary control/injection lines. The clamp design ensures adequate flow area around the ESP Bypass System completion while enabling the maximum stand-off between the ESP assembly and the well casing. This ensures fluid cooling to the ESP electric motors.

The Black Gator® 9-5/8" bypass clamp has adjustable jaws to fit 400 to 562 series ESP necks. The clamp has special gripping features to secure the clamp to the bypass tubing. The standard clamp fits 2-7/8" bypass tubing. Replacing the 2-7/8" inserts with 2-3/8" inserts will allow the same clamp to be used with 2-3/8" by-pass tubing.

The Black Gator 7" bypass clamp can be machined for 2-3/8" or 2-1/8" bypass tubing to fit 338 to 400 ESP neck sizes.

The clamps have universal cable clips on either side to grip 1/4" discharge pressure lines and the EPS MLE cable.

FEATURES

- Precision investment castings
- Robust field-proven designs
- Universal clamp for 9-5/8" casing
- Universal cable clip designs for flat MLE and 1/4" discharge pressure line

SPECIFICATIONS

Low alloy steel or 13Cr material options to specification API 5CT

Casing Size	Maximum OD of ESP (in.)					
	3.750	3.870	4.000	5.130	5.400	5.625
7" 23-26lb/ft	2.375	2.125	2.125	-	-	-
7" 29-35lb/ft	2.125	2.125	-	-	-	-
9-5/8" 40-47lb/ft	2.875	2.875	2.875	2.875	2.875	2.875
9-5/8" 53.5lb/ft	2.875	2.875	2.875	2.875	2.875	2.375