

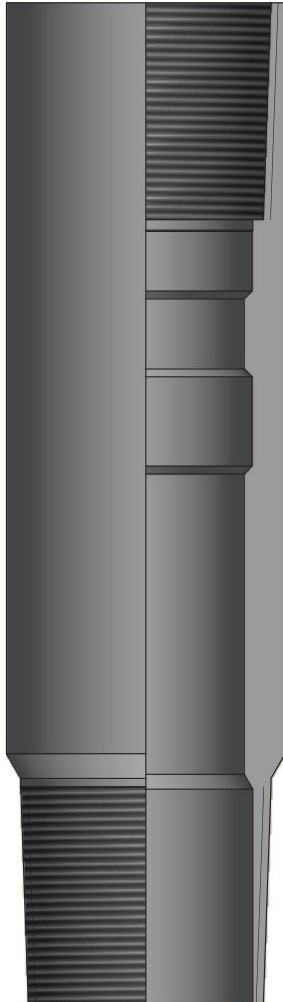

Black Gator® Top Nipple



The Black Gator® Top Nipple is positioned above the Y-Tool to provide the operator with a seal bore profile within the pressure tested assembly. Seating of a plug or standing valve in the Top Nipple seal bore enables the operator to pressure test the production tubing to the surface without a check valve above the pump discharge head. This ensures a fully tested system from the Electric Submersible Pump (ESP) to wellhead. The standing valve can also be used to set a hydraulic ESP packer.

The Top Nipple can accommodate an isolation tool to isolate the ESP, allowing for bull-heading of fluids directly through the bypass tubing. Additionally, this allows the upper ESP to be isolated in dual Y-Tool ESP applications while operating the lower ESP.

FEATURES

- Top NO-GO feature
- “D” Type locking profile for plugs
- Seal bore for plugs and isolation tools
- Other lock profiles available on request

SPECIFICATIONS

- Low alloy steel or 13Cr material options to specification API 5CT
- 5,000 psi MWP

Part Number	Casing Size (in.)	Box Thread (in.)	Pin Thread (in.)	Seal Diameter (in.)
N-2312D	7	2-7/8 6.4# FCJ	2-7/8 6.4# FCJ	2.312
N-2562D	9-5/8	3-1/2 9.2# FCJ	3-1/2 9.2# FCJ	2.562
N-2750D	9-5/8	3-1/2 9.2# FCJ	3-1/2 9.2# FCJ	2.750
N-2812D	9-5/8	3-1/2 9.2# FCJ	3-1/2 9.2# FCJ	2.812