

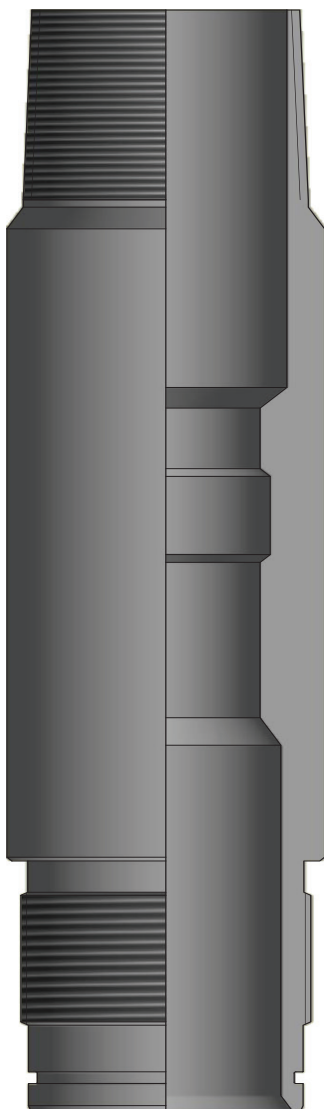

Black Gator® Bypass Nipple



The Black Gator® Bypass Nipple is situated at the top of the Bypass assembly immediately below the Y-Tool to provide a seal bore profile into which a Blanking Plug may be seated. Black Gator® Bypass Nipples are supplied with various seal bore and thread sizes to interface with various Y-Tool and bypass tubing configurations.

The seal bore also provides the sealing location for the lower part of the Isolation Tool, Wireline Logging Plug and Coiled Tubing Logging Plug.

The Bypass Nipple forms an integral part of the Y-Tool Assembly. It ensures the correct positioning of plugs to prevent recirculation.

FEATURES

- Top NO-GO feature
- “D” Type locking profile for plugs
- Seal bore for plugs
- Optional seal on bottom thread for dual ESP completions or tailpipe below an ESP

SPECIFICATIONS

- Low alloy steel or 13Cr material options to specification API 5CT
- 5,000 psi MWP

Part Number	Casing Size (in.)	Upper Pin Thread (in.)	Lower Pin Thread (in.)	Seal Diameter (in.)
TSN-2312D	9-5/8	3-1/2 9.2# FCJ	3.560-6 Stub ACME	2.312
TSN-2750D	9-5/8	3-1/2 9.2# FCJ	3.560-6 Stub ACME	2.750
TSN-1875D	7	2-7/8 6.4# FCJ	2.900-6 Stub ACME	1.875